

Extreme Angle Master Flash®

INSTALLATION GUIDE

Extreme Angle Size and Trimming

Extreme Angle Pipe Range

Closed Top

- 1 2-1/2" - 3-1/4" (64-93mm)
- 2 3-3/4" - 4" (83-102mm)
- 3 4" - 4-1/2" (102-114mm)
- 4 4-1/2" - 5-1/4" (114-133mm)
- 5 5-1/4" - 5-3/4" (133-146mm)

#1

Closed Top

- 1 2-1/2" - 3-1/4" (64-93mm)
- 2 3-3/4" - 4" (83-102mm)
- 3 4" - 4-1/2" (102-114mm)
- 4 4-1/2" - 5-1/4" (114-133mm)
- 5 5-1/4" - 5-3/4" (133-146mm)

#2

- 1 4" - 4-1/2" (101-114mm)
- 2 4-1/2" - 4-7/8" (114-123mm)
- 3 4-7/8" - 5-3/8" (123-136mm)
- 4 5-1/2" - 6" (139-152mm)
- 5 6" - 6-5/8" (152-168mm)
- 6 6-5/8" - 7-1/4" (168-184mm)
- 7 7-1/4" - 8" (184-203mm)

* Note This is the
#1 Extreme Angle
For Reference

****Base Dimension: #1 1" (279mm) | #2 14-1/4" (362mm)**

**The built in 20° pitch allows adaptability to
almost any roof pitch including 45°**

- * Find pipe size in table and trim Extreme Angle Master Flash® as shown on outline.
- * Use one size larger Extreme Angle Master Flash® on steep roofs or deep corrugation.
- * Cut the flashing at least 20% less then the pipe Outer Diameter

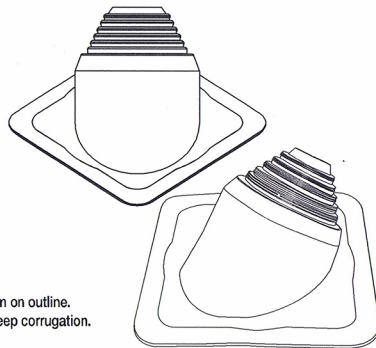

5 Easy Steps Installation Materials: Extreme Angle Master Flash® | Fasteners | Washers | Snips/Scissors | Measuring Tape | Marker/Pencil | Sealant

Measure & Trim



Slide



Form



Seal



Complete

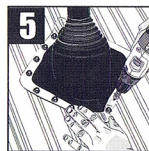

Roof Pitch Calculator
<https://ipc.aztecwash.com>

Note: Properly installed the base with Master Seal® Bonded Washers and fasteners. Fasteners should be 1" - 1-1/2" apart around the entire base for a tight secure seal.



Installation Video: <http://www.aztecwasher.com/installationvideos>

Extreme Angle Master Flash® is a product of Aztec Washer Company 4/2020